

Residence 3

ASCEND



PRICE
\$1,489,057

FEATURES

-  4 Bedrooms
-  4 Ba
-  1,944 Sq. Ft.
-  2 Car Garage

30 YEAR FIXED RATE INCENTIVE - [LEARN MORE HERE!](#)

Ascend by Trumark Homes is in **Final Opportunity** with limited homes remaining!

Plan 3 at Ascend is an expansive three-story townhome offering approximately 1,944 Sq. Ft. of living space. Upon entry, you are greeted with stairs up to the main living along with a secondary bedroom, bathroom and access to the garage. The second floor features a gourmet kitchen, including a center preparation island overlooking the dining are, living room, and deck. The kitchen includes recessed-panel Beech Shaker cabinetry, chrome knobs, granite slab kitchen countertops with a 6" backsplash. Whirlpool stainless steel kitchen appliances are also included. Beyond the kitchen is a secondary bedroom, complete with a bathroom and closet. The third floor features an additional secondary bedroom with a walk-in closet and an ensuite full bath. Down the hall is the spacious primary suite with a stunning spa-like bathroom with dual sinks, a large walk-in shower, and a spacious walk-in closet. This home also comes with your choice of three luxury vinyl plank flooring at entry, kitchen, laundry, and bathrooms, your choice of three carpet flooring in bedrooms, Kohler plumbing features, and much more!

* CONTACT OUR SALES TEAM FOR MORE DETAILS ABOUT THIS AMAZING PROMOTION!

Residence 3

ASCEND

GET IN TOUCH
(925) 281-3227

ASCEND

RESIDENCE 3

4 Bedrooms, 4 Baths, 2-Car Garage
Approx. 1,944 Finished Sq. Ft.

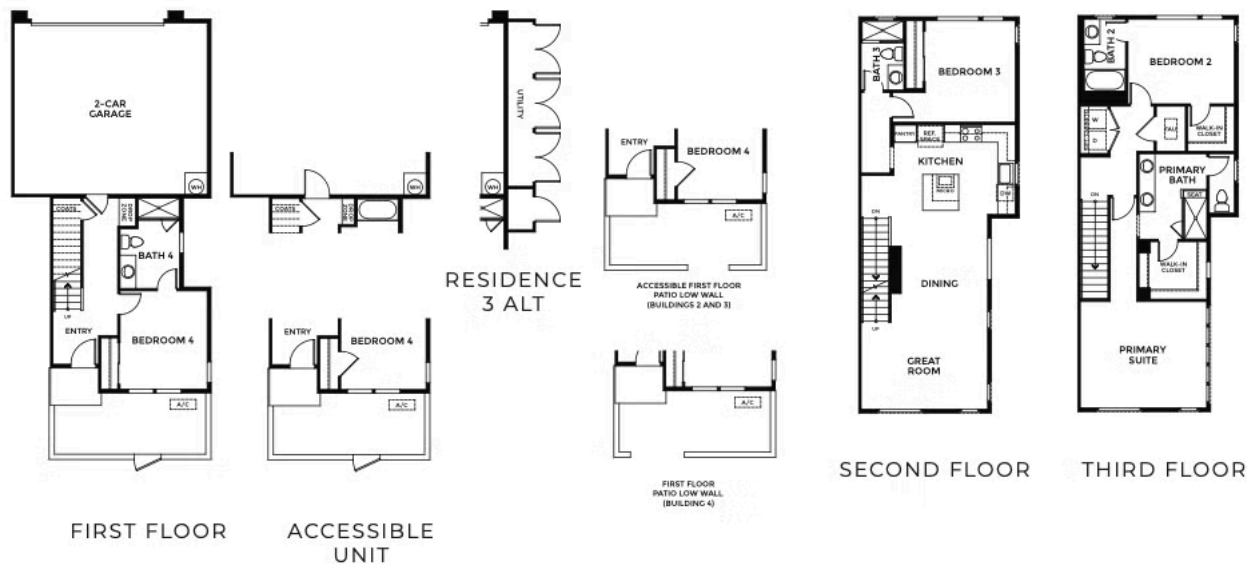

PRELIMINARY

Preliminary and subject to change. 925.281.3227 | Sales@Trumarkhomes.com | 905 N. Capitol Avenue, San Jose, CA 95133 | VIP-ASCEND.COM

TRUMARKHOMES

All information is for reference only. Prices, taxes and specifications subject to change and should be verified by all potential homebuyers. This is not an offer to sell but is intended for information only. The developer reserves the right to make modifications in materials, specifications, plans, pricing, various fees, designs, scheduling and delivery of homes without prior notice. All dimensions and square footages are approximate. Plan and dimensions may contain minor variations from floor to floor. CA DRE license no. 01877720. 